



Northstar
Surveying

(320)693-3710
310 East Depot Street
Litchfield, MN 55355
dough.northstar@gmail.com
chuck.northstar@gmail.com

CLIENT NAME:
Steffes / Harnden

PROJECT ADDRESS
74402 560th Avenue
Jackson, MN

DATE OF FIELD WORK: July 17, 2023
DATE OF MAP: July 19, 2023
REVISION: _____ DATE _____, 20____
REVISION: _____ DATE _____, 20____

JOB NO.: 2023156
DRAFTED BY: PMH
CHECKED BY: DSH

HORIZONTAL DATUM:
Jackson County
NAD83 (2011)
VERTICAL DATUM:
N/A

Surveyed Description

LEGAL DESCRIPTION FOR TRACT A

The North 740.00 feet of the West 990.00 feet of the Southwest Quarter (SW1/4) of Section Eight (8), Township One Hundred One (101), North of Range Thirty-four (34), West of the Fifth Principal Meridian, Jackson County, Minnesota.

Containing 16.82 Acres, more or less.
Subject to easements of record.
Subject to any and all enforceable restrictive covenants.

LEGAL DESCRIPTION FOR TRACT B

That part of the Southwest Quarter (SW1/4) lying southwesterly of the centerline of CSAH 23, as presently established in Section Eight (8), Township One Hundred One (101), North of Range Thirty-four (34), West of the Fifth Principal Meridian, Jackson County, Minnesota.

Containing 23.17 Acres, more or less.
Subject to easements of record.
Subject to any and all enforceable restrictive covenants.

CERTIFICATION: I hereby certify that this survey was prepared by me or under my direct supervision and that I am a Professional Licensed Surveyor under the Laws of the State of Minnesota.

Doug Huhn
Doug Huhn
Registration No. 43808 - In the State of Minnesota

Surveyor's Notes

- 1: Northstar Surveying prepared this survey without the benefit of a current abstract or title work. We reserve the right to revise the survey upon receipt of a current title commitment or title opinion.
- 2: Northstar Surveying was not contacted to locate the size, location, or existence of any/all easements, right-of-way lines, setback lines, agreements or other similar matters.
- 3: Subsurface buildings, improvements and/or Environmental issues may exist on site that we were not made aware of and therefore were not examined or considered during the process of this survey.

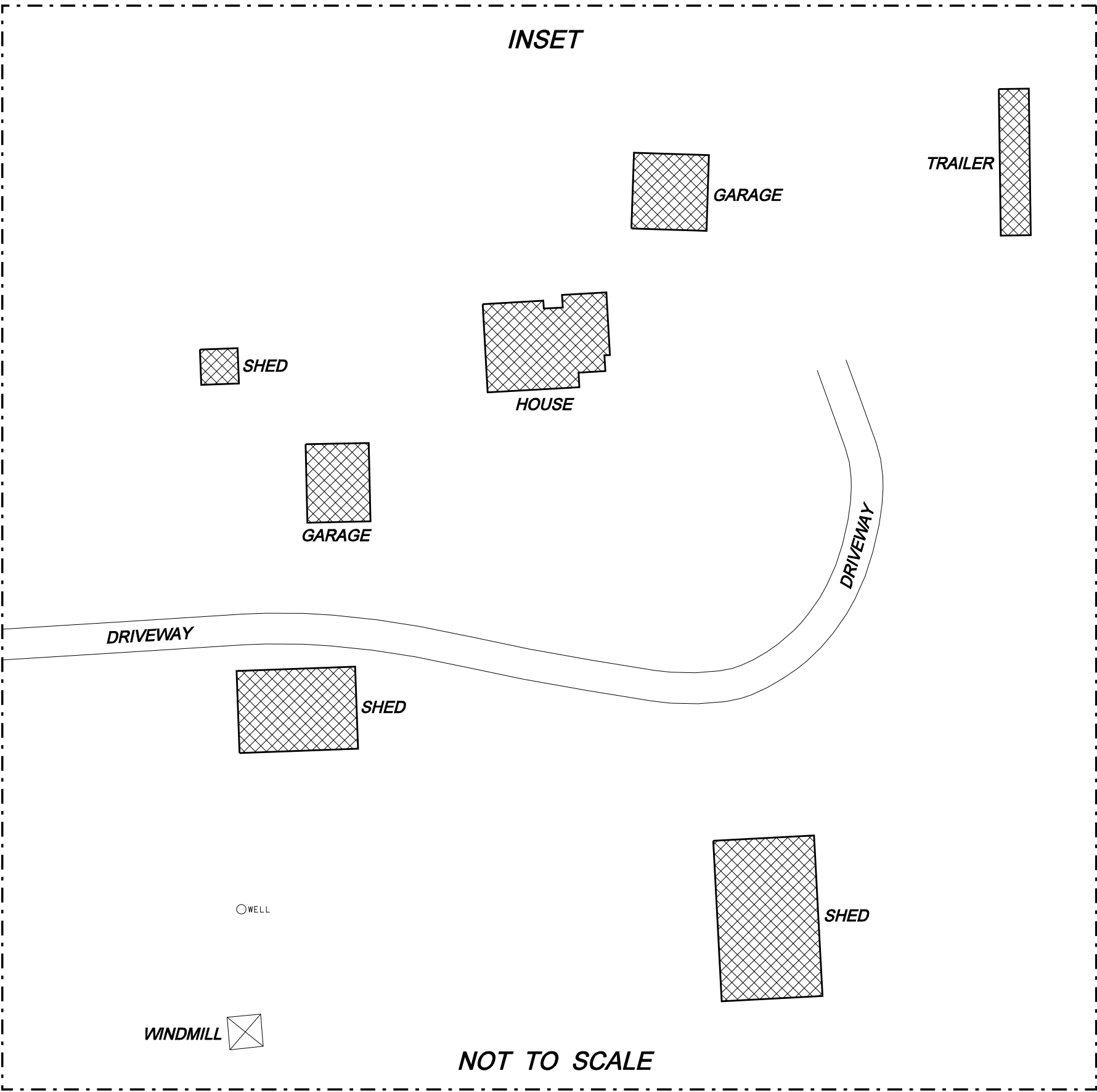

LEGEND

- Set 1/2 Inch by 14 Inch Iron Pipe with Plastic Cap Inscribed with License No. 43808
- Found Monumentation
- ⊙ Government Section Corner

GRAPHIC SCALE

